

ASSEMBLY INSTRUCTION

SB2 ORIKU

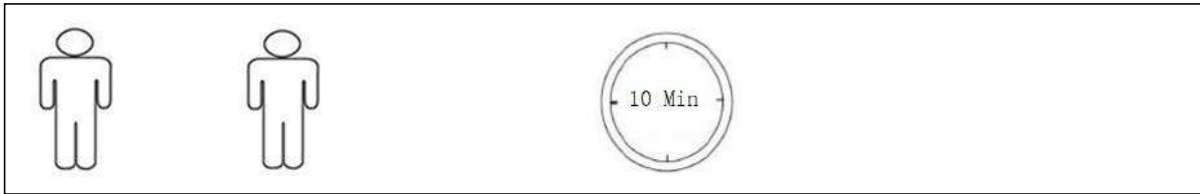
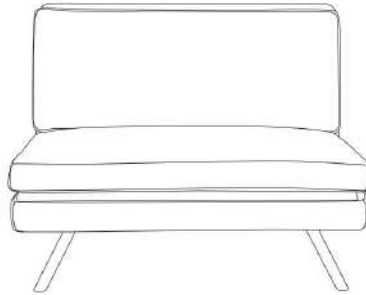

Step 1:

To used as a sofa ,open zippers under the futon, find 4 hidden legs .Lift them until you hear clicking sound.

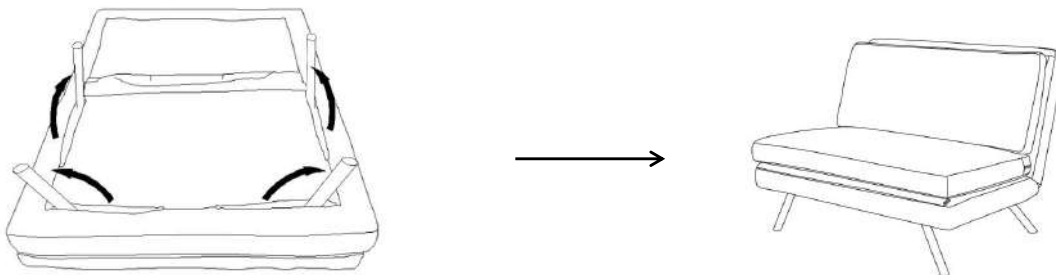

Step 2:

To used as a seat cushion,find the spring pin at the end of legs,pull it all along and flip down the legs.

(Warning:be careful not to trap fingers when opening and closing.)

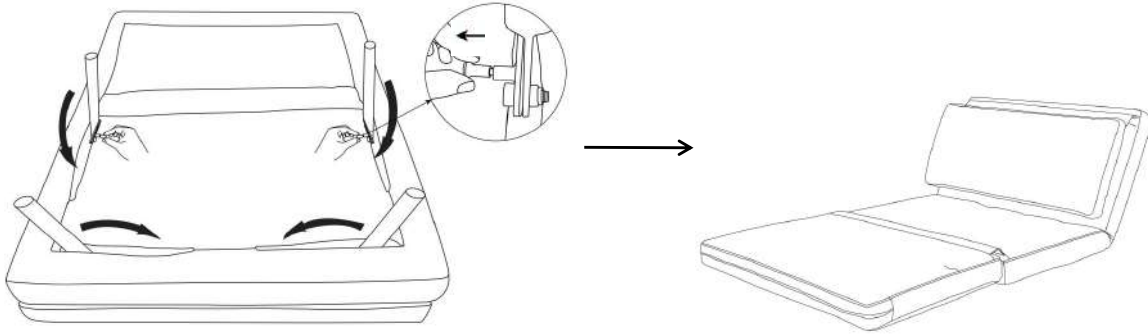

Step 4:

You can also unfold the cushion to bed position.

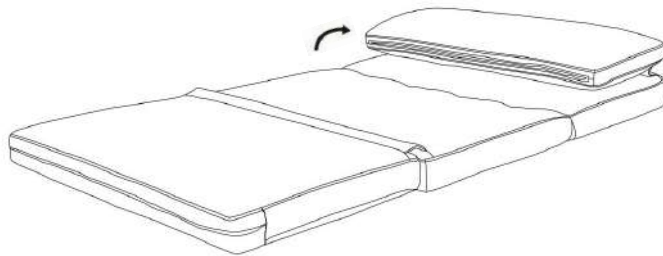

Step 5: